

MEGALINEAR T5 WIDE OPEN-END

BELT CHARACTERISTICS

STANDARD WIDTHS (mm)	250	500
Weight (gr/m)	500	1000

- Standard compound: transparent Polyurethane thermoplastic 90 ShA
- Standard back cover: none
- Standard tooth cover: none
- Standard cords: S and Z torsion kevlar at pitch 3,5 mm
- Standard width tolerance: +/- 2 mm
- Standard thickness: 2,3 +/- 0,15 mm
- Standard length tolerance: +/- 0,8 mm/m
- Standard roll length: 100 m
- Belt options on request with minimum quantity:
 - Nylon fabric back
 - Nylon fabric teeth
 - Transparent FDA compound

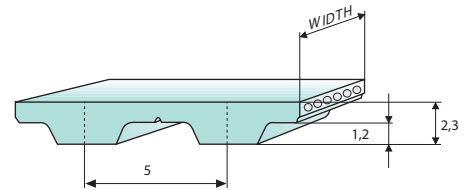
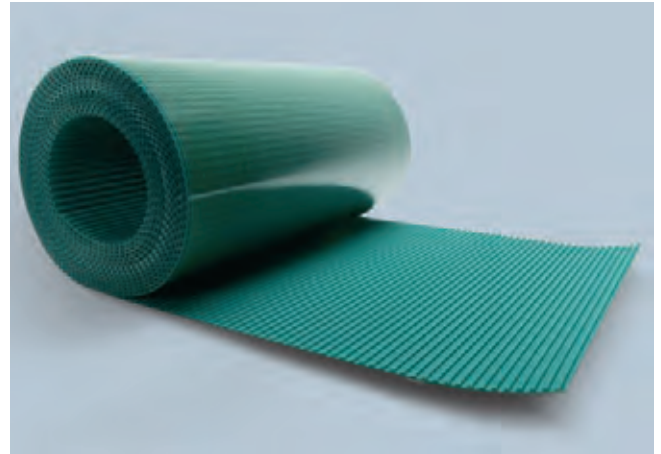

TOOTH RESISTANCE

RPM (1/min)	0	20	40	60	80	100	200	300	400	500	750	1000	1500	2000	3000	4000	5000	8000
F _{p spec} (N/cm)	17	16	15	15	15	15	14	13	13	12	12	11	-	-	-	-	-	-

TRACTION RESISTANCE

Belt width (mm)	250	500
Kevlar Max Traction Load (N)	5300	1060
Breaking Strength (N)	18550	37100
Elongation at MTL (mm/m)	8	8
Average values		



MEGALINEAR T5 WIDE OPEN-END

FLEXION RESISTANCE

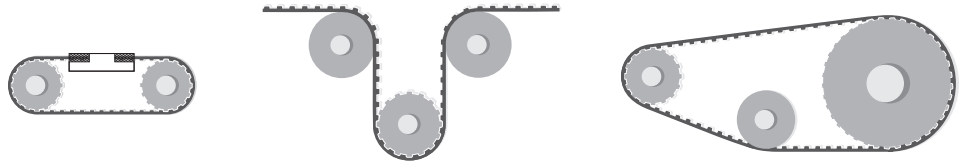

	Z min	Z min	Idler min dia (mm)	Z min	Idler min dia (mm)
Kevlar cords	12	15	45	12	45

JOINED BELT INFORMATIONS

- Traction and tooth resistances = 50% less than open-end
- Joined belt can be used only in conveyor systems
- Rolls with NFT and NFB can be joined too
- Minimum diameters according above table



PULLEYS (for more details please see our pulleys catalogue)

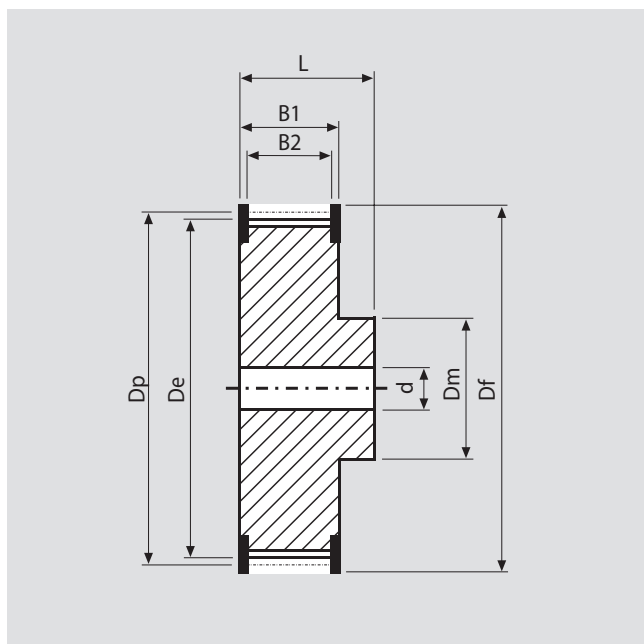

N° Teeth	Dp	De	N° Teeth	Dp	De
12	38,20	36,35	26	82,76	80,91
14	44,56	42,71	27	85,94	84,10
15	47,75	45,90	28	89,13	87,28
16	50,93	49,08	30	95,49	93,65
18	57,30	55,45	32	101,86	100,01
19	60,48	58,63	36	114,59	112,74
20	63,66	61,81	40	127,32	125,48
22	70,03	68,18	44	140,06	138,21
24	76,39	74,55	48	152,79	150,94
25	79,58	77,73	60	190,99	189,14